

INSTRUCTIONAL GUIDE

SP600 SMART POINTER

1 Insert batteries into the Remote

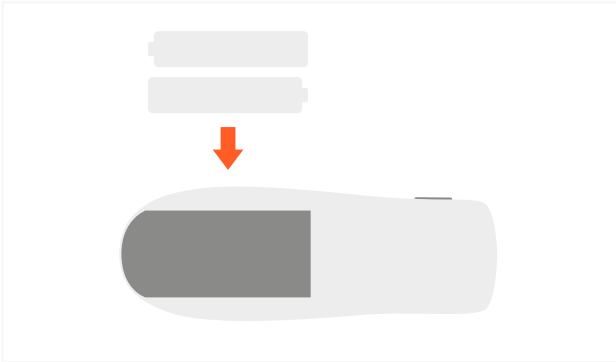

2 Plug USB receiver into USB port on computer

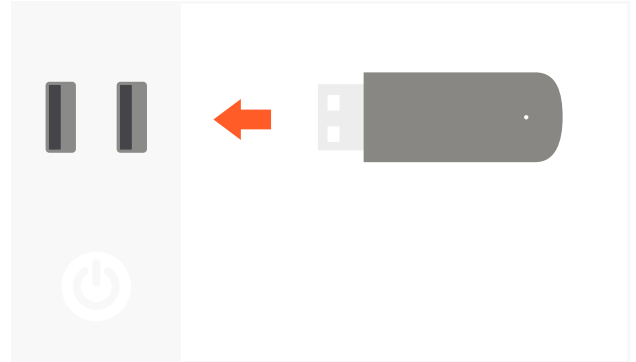

3 While the LED light on the receiver is blinking, press and hold any button (except the laser button) on the remote for 3-4 seconds, to allow the remote to communicate with the receiver. The LED light will turn off

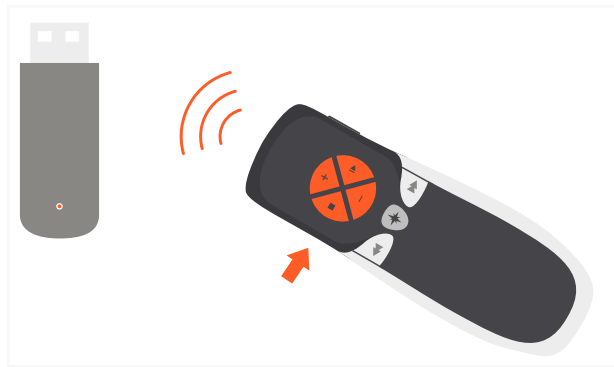

4 Slide mode switch to P.T. to control PowerPoint and Keynote

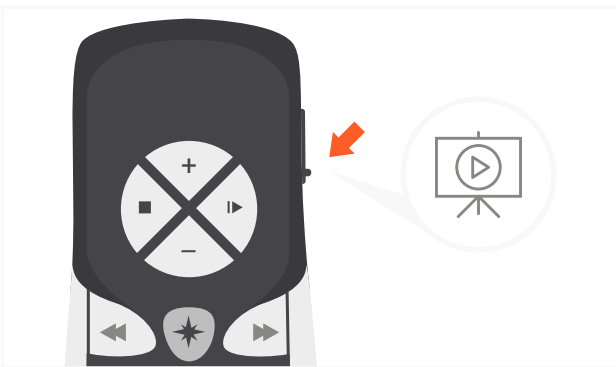

5 Slide mode switch to mouse mode to control computer mouse cursor

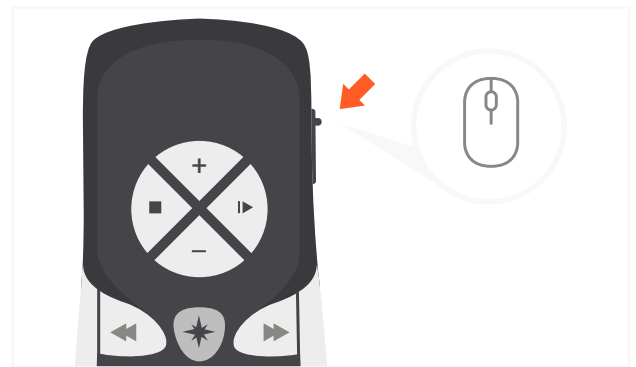

FOR BUTTON CUSTOMIZATION, DOWNLOAD SMART KEYMAP SOFTWARE UTILITY



FOR PC



FOR MAC