

ONTHEGO™ POWER BANK (5K)

SKU: ST-B5Q2SK / ST-B5Q2SW / ST-B5Q2SR

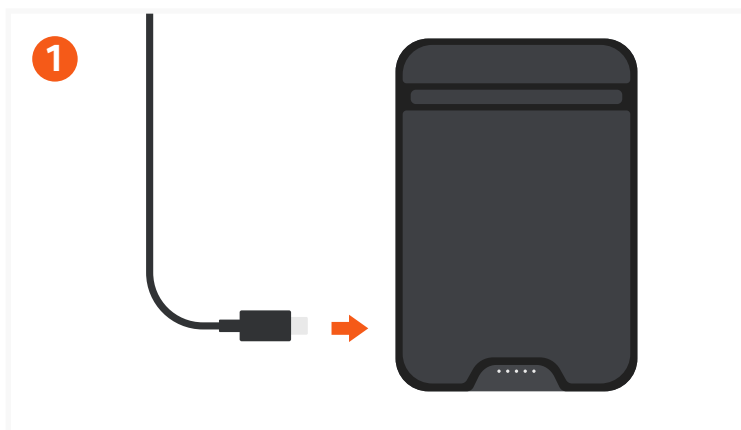

Before first use, please fully charge the OntheGo™ Power Bank via USB-C port using the included cable.

White LED lights will flash when the power bank is charging. Four LED lights will illuminate when fully charged.



Turn on the power bank by pressing the side button once or attaching your phone. The LED lights will turn on for 14 seconds and then turn off. The power bank supports wireless charging for one device at a time.

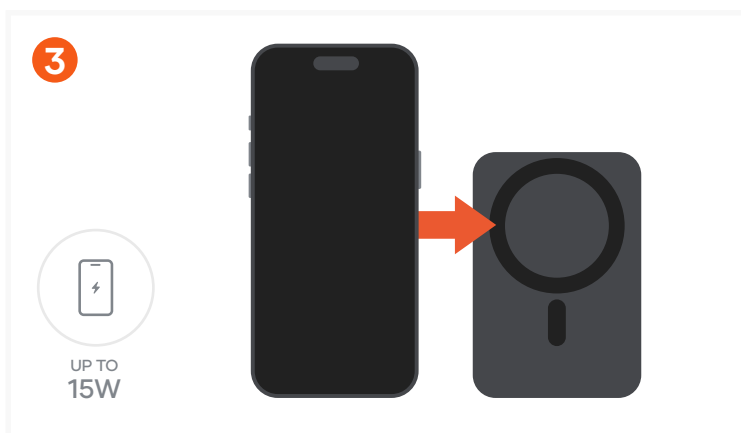

Place your phone on the wireless charger.

Maximum Wireless Output: 15W.

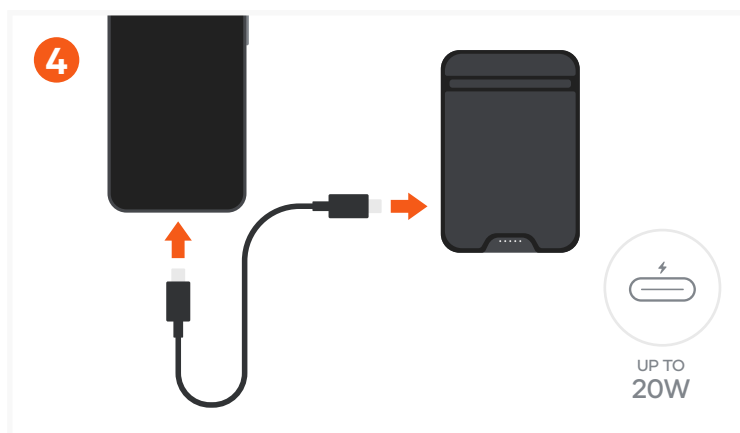

Use the USB-C port to recharge the power bank or charge USB-C tablets or smartphones.

Maximum Input/Output: 20W.

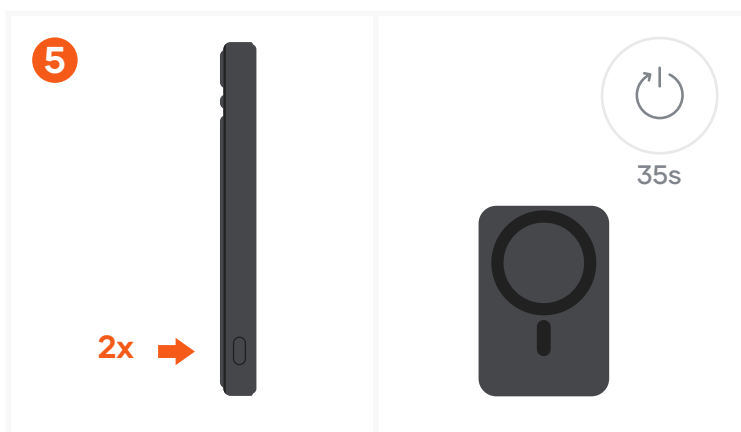

To manually power off the power bank, double-press the power button. The LED battery indicators will turn off. The power bank also features an auto-shutoff function, which activates after 35 seconds of inactivity or if no connected device is detected.

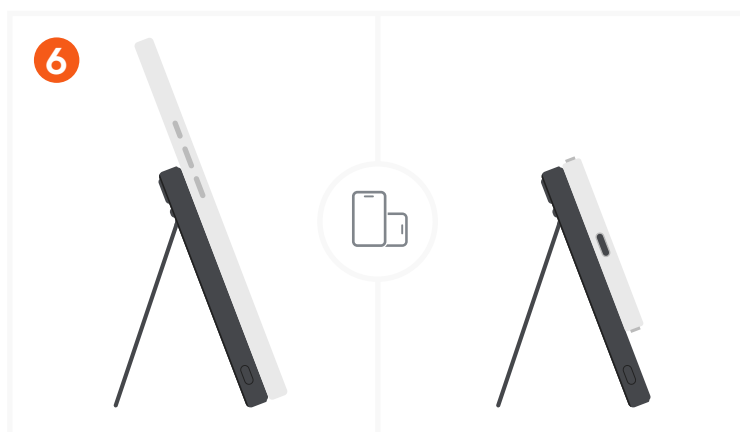

The power bank can function as a stand, supporting both portrait and landscape orientations.

CHARGING BEHAVIOR & INDICATORS

7

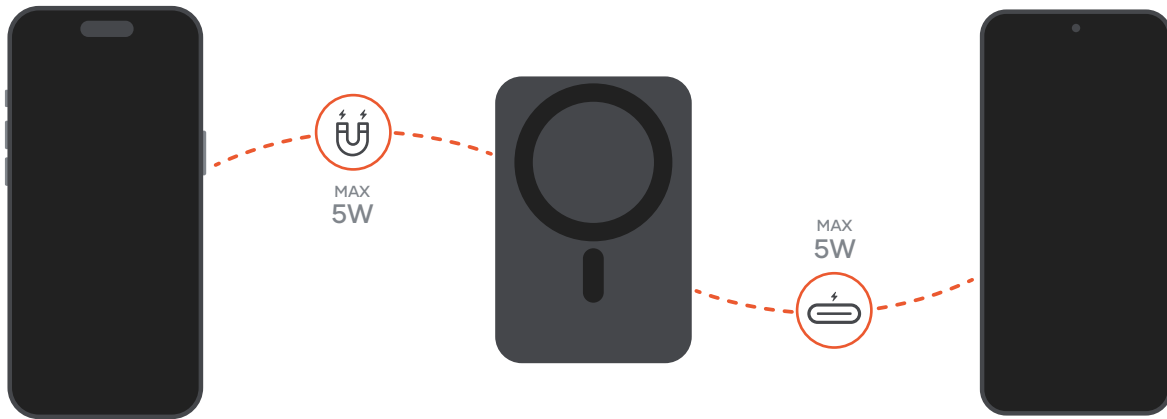

When charging two devices simultaneously (wireless + USB-C), the output will follow this configuration:
Qi2 Charger (5W) + USB-C Output (5W)

8

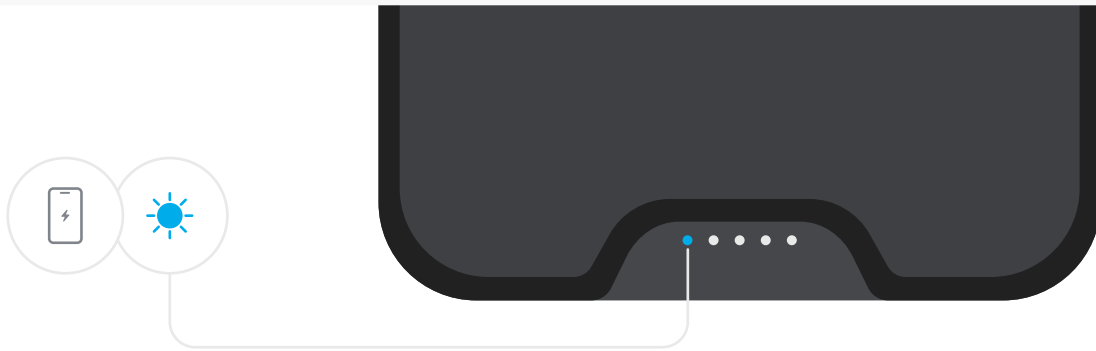

When a device is charging, the Blue LED light will remain solid, confirming the device has been detected and is charging properly.

A blinking Blue LED light signals that no device has been detected, or charging is not in progress.

9

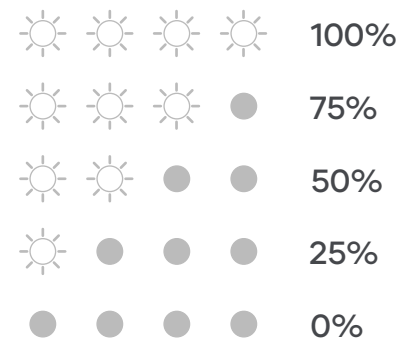
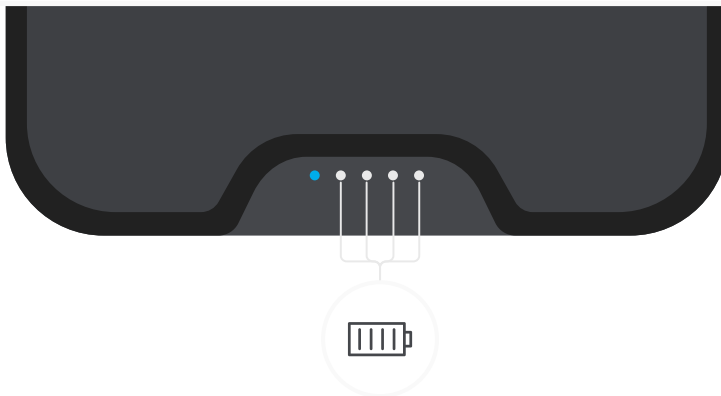

LED indicators on the back of the power bank display the current battery level. These lights will turn on upon power on showing the battery level and will remain on while charging.

You can also press the power button once to check the current battery level at any time.