



This device complies with part 15 of the FCC results.
Operation is subject to the following two conditions:

1. This device may not cause harmful interference and
2. This device must accept any interference received, including interference that may cause undesired operation.

Note: This Equipment has been tested and found to comply with the limits for a class B digital device, pursuant to Part 15 of the Federal Communications Commission (FCC) rules. These limits are designed to provide reasonable protection against harmful interference in a residential installation. This equipment generates, uses, and can radiate radio frequency energy and, if not installed and used in accordance with the instructions, may cause harmful interference to radio communications. However, there is no guarantee that interference will not occur in a particular installation. If this equipment does cause harmful interference to radio or television reception, which can be determined by turning the equipment off and on, the user is encouraged to try to correct the interference by one or more of the following measures:

- 1.1. Reorient or relocate the receiving antenna
- 1.2. Increase the separation between the equipment and receiver
- 1.3. Connect the equipment into an outlet on a circuit different from that to which the receiver is connected
- 1.4. Consult the dealer or an experienced radio/TV technician for help

Changes or modifications not expressly approved by the manufacturer could void the user's authority operate the equipment.



Satechi declares that this product is in compliance with the essential requirements and other relevant provisions of applicable EC directives. For Europe, a copy of the Declaration of Conformity for this product may be obtained by visiting www.satechi.net/doc



According to the WEEE (Waste Electrical and Electronic Equipment) Directive, do not dispose of this product as household waste or commercial waste. Waste electrical and electronic equipment should be appropriately collected and recycled as required by practices established for your country. For information on recycling of this product, please contact your local authorities, your household waste disposal service, or the shop where you purchased the product.

+1 858 268 1800 support@satechi.com

PLUG & PLAY

PLUG & PLAY | PLUG & PLAY | PLUG & PLAY |
PLUG & PLAY | プラグ&プレイ

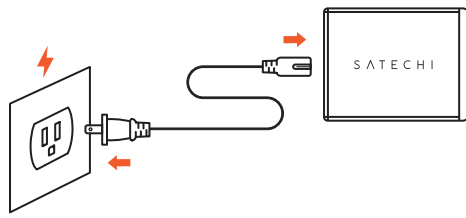

1. Connect the charger to a power outlet

Connectez le chargeur à une prise de courant
Conectar el cargador a una toma de corriente
Schließen Sie das Ladegerät an eine Steckdose an
Collegare il caricatore ad una presa di corrente
充電器をコンセントに接続します

2. Connect your devices

Connectez vos appareils
Conecta tus dispositivos
Schließen Sie Ihre Geräte an
Collega i tuoi dispositivi
デバイスを接続する

S A T E C H I

108W PRO USB-C PD DESKTOP CHARGER



User Manual | Manuel d'utilisation |
Manual de usuario | Bedienungsanleitung |
Manuale dell'utente | ユーザーマニュアル

FUNCTIONS

FONCTIONS | FUNCIONES | FUNKTIONEN | FUNZIONI |
機能

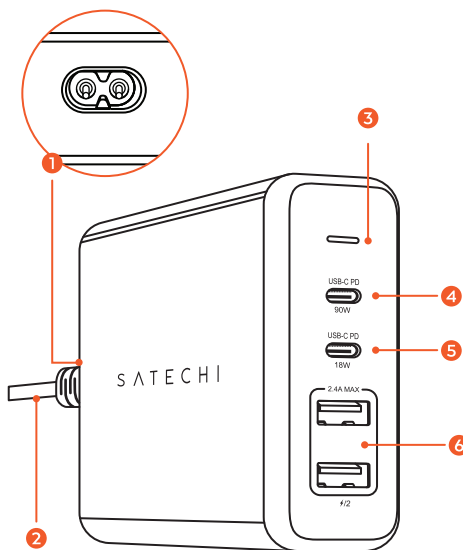

1. 2-Pin Power Connector

Connecteur d'alimentation à 2 broches | Conector de energia de 2 pines | 2-poliger Stromanschluss | Connettore di Alimentazione a 2-Pin | 2ピン電源コネクタ

2. Power Cable (included)

Câble d'alimentation (inclus) | Cable de carga (incluido) |
Netz Kabel (im Lieferumfang enthalten) | Cavo di ricarica (incluso) |
電源ケーブル (付属)

3. LED Indicator

Indicateur LED | Indicador LED | LED-Anzeige | Indicatore LED |
LED インジケータ

4. USB-C Charging Port (90W Max.)

Port de charge USB-C (90W Max.) | Puerto de Carga USB-C (Máx.
90W) | USB-C Ladeanschluss (max. 90W) | Porta di Ricarica
USB-C (Mass. 90W) | USB-C 充電ポート (最大90W)

(PD) 5V/9V/12V/15V = 3A, 20V = 4.5A
(QC3.0) 3.6V-6V = 3A, 6V-9V = 2A, 9V-12V = 1.5A

5. USB-C Charging Port (18W Max.)

Port de charge USB-C (18W Max.) | Puerto de Carga USB-C (Máx.
18W) | USB-C Ladeanschluss (max. 18W) | Porta di Ricarica
USB-C (Mass. 18W) | USB-C 充電ポート (最大18W)

(PD) 5V = 3A, 9V = 2A, 12V = 1.5A, 15V = 1.2A
(QC3.0) 3.6V-6V = 3A, 6V-9V = 2A, 9V-12V = 1.5A

6. 2 X USB-A Charging Port (Total 12W Max.)

2 Ports de Charge USB-A (Total Max. 12W) | 2 Puertos de Carga
USB-A (Total Máx. 12W) | 2 x USB-A Ladeanschluss (maximal
12W) | 2 Porte di Ricarica USB-A (Totale Mass. 12W) |
2つのUSB-A充電ポート (合計12W最大)

IMPORTANT

IMPORTANT | IMPORTANTE | WICHTIG | IMPORTANTE |
重要

- For the fastest and safest charge, please use the original device cable or a certified one.

• Pour une charge la plus rapide et la plus sûre, veuillez utiliser le câble d'appareil d'origine ou un câble certifié.

• Para una carga rápida y segura, favor de utilizar el cable original del dispositivo o uno certificado.

• Verwenden Sie für die schnellste und sicherste Aufladung das Originalkabel des Geräts oder ein zertifiziertes Kabel.

• Per una ricarica rapida e sicura, si prega di utilizzare il cavo originale del dispositivo o certificato.

• 最速で安全な充電を行うには、オリジナルのデバイスケーブルまたは認定されたケーブルを使用してください。

- Keep away from water, liquid, and moisture.

• Tenir à l'écart de l'eau, des liquides et de l'humidité.

• Mantener lejos del agua, líquido y humedad.

• Von Wasser, Flüssigkeiten und Feuchtigkeit fernhalten.

• Tenere lontano da acqua, liquidi e umidità.

• 水、液体、湿気を避けてください。