

# 4 PORT USB 3.0 ALUMINUM HUB

- 1 Plug the included USB cable into the port on the left side of the Hub and connect it to USB 3.0 port of your computer or laptop.

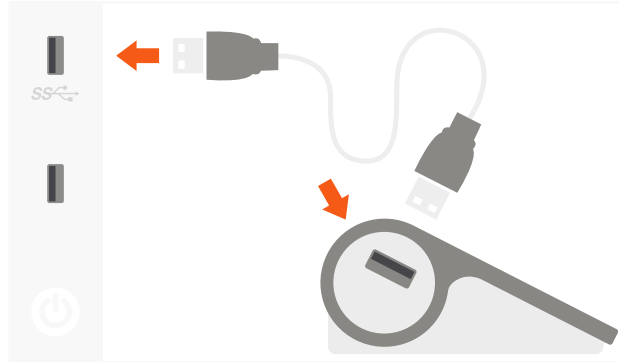

- 2 Connect up to 4 USB devices like external hard drives, cameras, flash drives, keyboards. Forward and backward compatibility between USB 3.0 and 2.0 / 1.1 hosts and devices.

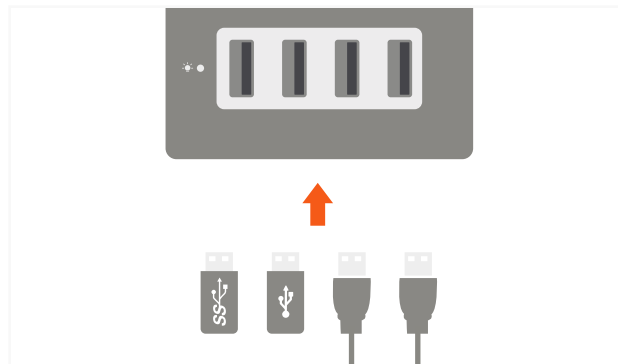

- 3 The hub is not a standalone charger and will not charge phones or tablets. Not recommended for use with USB 3.0 PCI-e add-on cards and Apple Super Drive.

