

ONTHEGO™ BLUETOOTH MOUSE

SKU: ST-MOTGK / ST-MOTGW

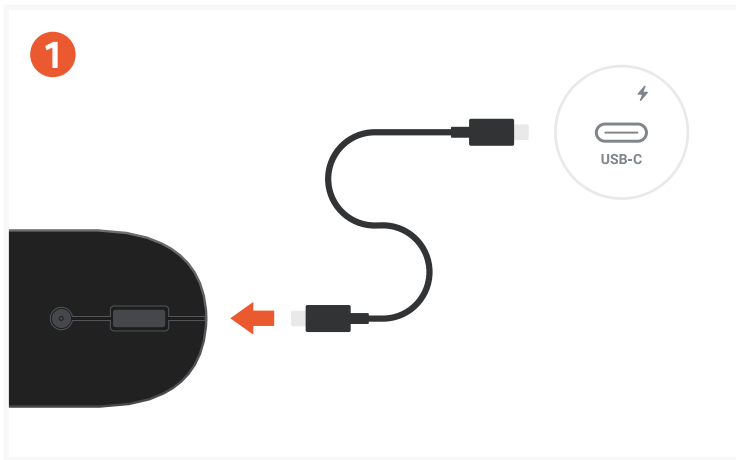

Before use, please fully charge the OntheGo™ Bluetooth Mouse via USB-C port using its included cable.



Turn on the OntheGo™ Bluetooth Mouse using its backside power switch. Be sure to remove the clear adhesive film from the bottom of the mouse before use.



Put the mouse into pairing mode. Press and hold the Bluetooth button for 3-5 seconds. The LED will flash white.

You will be able to pair up to three devices.

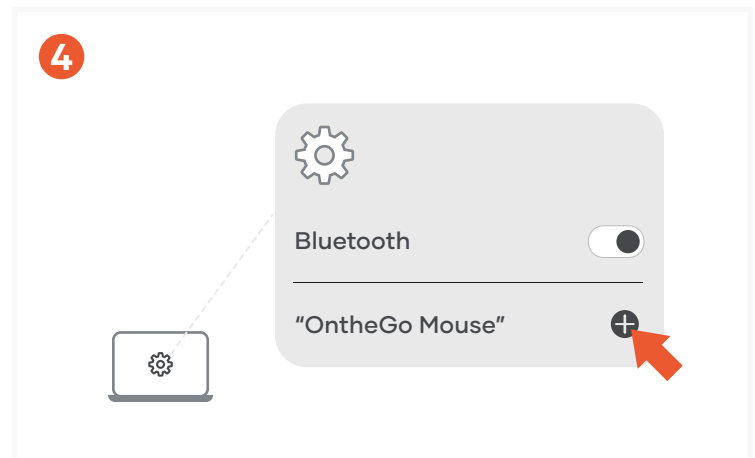

Turn on Bluetooth on your device and select "OntheGo Mouse" from the list. Click "Connect" to finish the connection process.

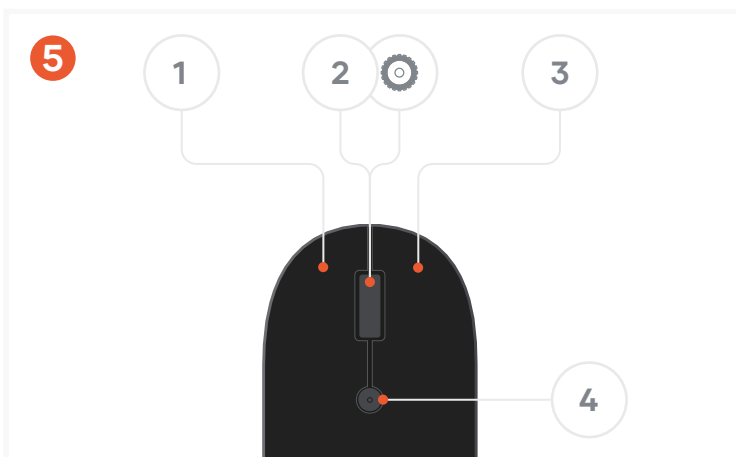

The mouse is equipped with 4 buttons and a scroll wheel.

The center button is to control the DPI sensitivity of your cursor that can be set to 800, 1200, 1600, 2400.

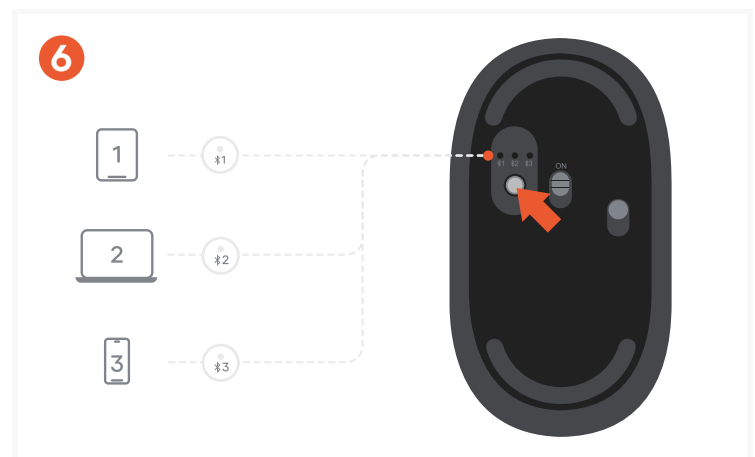

Press the pairing button to switch between Bluetooth channels (1, 2, or 3).

An LED above the active channel will light up to indicate your current connection.