

FINDALL™ LUGGAGE TAG

SKU: ST-LFALTK / ST-LFALTW / ST-LFALTR

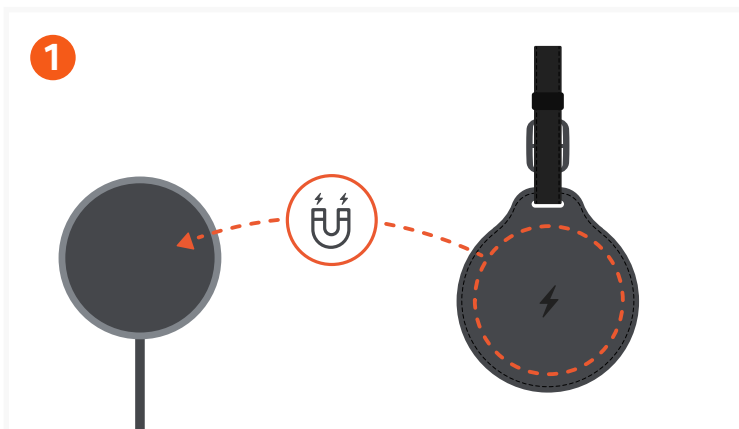

Charge the Luggage Tag with a wireless charger (not included). The status light will be orange while charging and green when fully charged.

It is recommended to charge once every 6 months. Battery life lasts up to 8 months* on a single charge (may vary depending on usage).



To power off the Luggage Tag, quickly press the power button 2 times, then long press the 3rd time for at least 5 to 7 seconds. You will hear two beeps, indicating your FindAll™ Luggage Tag is powered off. When device is powered off, you cannot track its location.

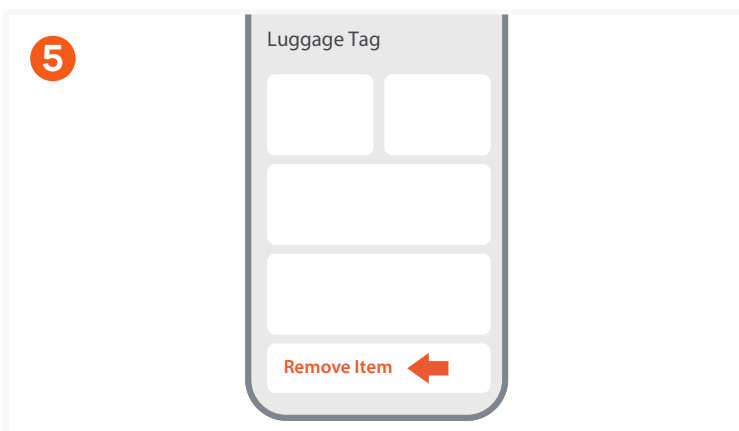

To remove the Luggage Tag, open the Find My app, tap the Luggage Tag under **Items**, tap **Remove Item**, tap **Remove**, and confirm to remove.

If unable to pair with a new device, a factory reset must be done.

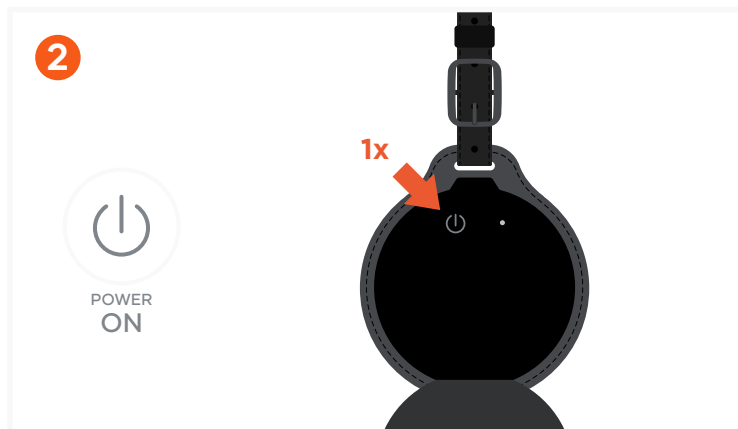

To power on the Luggage Tag, press the power button once. It will beep to indicate it is on.

If not paired within 10 minutes, it will beep and automatically power off.

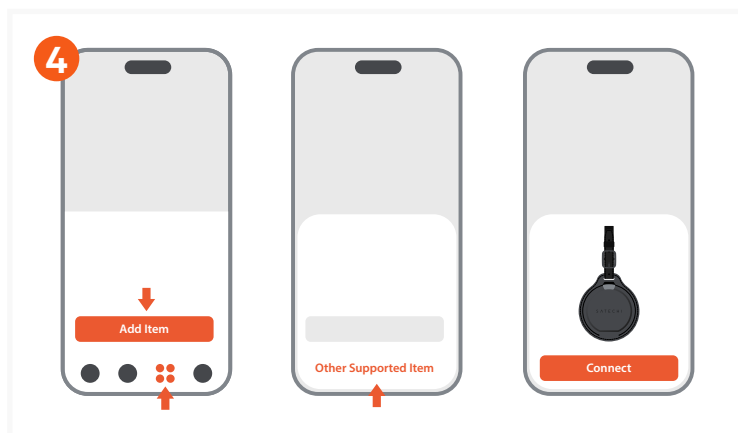

To pair the Luggage Tag, open the Find My app, tap **Add Item** under **Items**, and tap **Other Supported Item**. Once "Satechi FindAll™ Luggage Tag" is detected, tap **Connect**.

Do not leave the app while pairing the device.

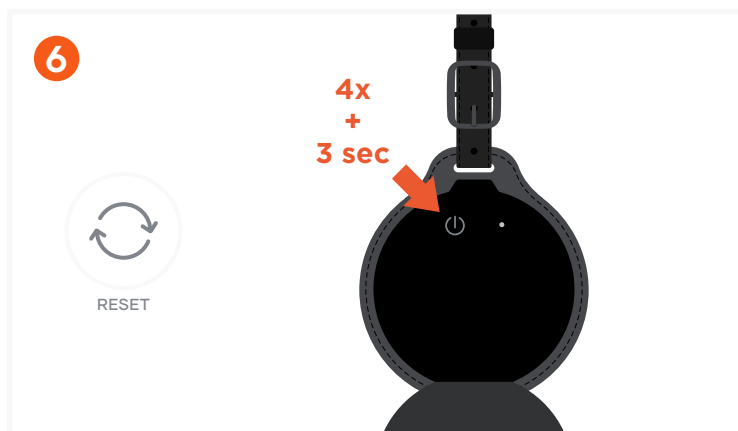

To factory reset the Luggage Tag, quickly press the power button 4 times, then long-press for at least 3 seconds, then you will hear a beep confirming the Luggage Tag has been reset.