

Dimension: 90 x 110 mm

OUTSIDE



FCC Statement
This device complies with part 15 of the FCC rules. Operation is subject to the following two conditions: (1) This device may not cause harmful interference, and (2) this device must accept any interference received, including interference that may cause undesired operation.



CE DECLARATION OF CONFORMITY
Satechi declares that this product is in compliance with the essential requirements and other relevant provisions of applicable EC directives.



WEEE Information
According to the WEEE (Waste Electrical and Electronic Equipment) Directive, do not dispose of this product as household waste or commercial waste.

CAN ICES(B)/NMB(B)
This Class B digital apparatus complies with Canadian ICES(B). (Cet appareil numérique de la Classe B conforme à la norme NMB(B) du Canada).

AUSTRALIAN CONSUMER LAW
Our goods come with guarantees that cannot be excluded under the Australian Consumer Law. You are entitled to a replacement or refund for a major failure and compensation for any other reasonably foreseeable loss or damage.

MODEL NUMBER : MN25STH08



NEED HELP?

BESOIN D'AIDE ? | ¿NECESITA AYUDA? | BENÖTIGEN SIE HILFE? | HAI BISOGNO DI AIUTO? | PRECISA DE AJUDA? | YARDIMA MI IHTIYACINIZ VAR? | 助けが必要ですか?

Manufacturer:
7365 Mission Gorge Rd. Ste. G
San Diego, CA 92120, USA
+1 858 268 1800
support@satechi.com
www.satechi.net

EU Authorized Representative:
Chemical Inspection and Regulation
Service Limited
CIRS, Regus Harcourt Centre
Dublin, Ireland, D02 HW77
+353 1 477 3710

UK Representative:
Chemical Inspection and Regulation
Service UK Ltd.
Unit 536, Salisbury House
London Wall, London, EC2M 5SQ
+44 20 3289 6395

ST-MULX(x)\_LX\_WMmouse\_UM\_RevA

S A T E C H I

SLIM LX WIRED MOUSE



USER MANUAL

Manuel de l'utilisateur | Manual de usuario | Benutzerhandbuch |
Manuale utente | Manual de usuário | Kullanım kılavuzu |
ユーザーマニュアル

INSIDE

PLUG & PLAY

CONNECTER ET UTILISER | CONEXIÓN Y USO | ANSCHLIEßEN UND VERWENDEN | COLLEGARE E USARE | LIGAR E USAR | BAĞLA VE KULLAN | 接続して使用する

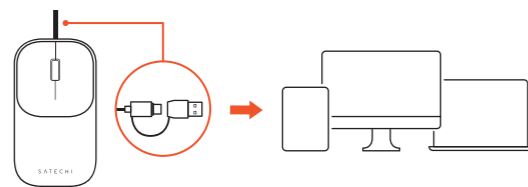

• Plug into USB-C or USB-A port and the mouse will be detected by the device.

Branchez dans le port USB-C ou USB-A et la souris sera détectée par l'appareil.
Conectar al puerto USB-C o USB-A y el dispositivo detectará el ratón.
In den USB-C- oder USB-A-Anschluss stecken, und die Maus wird vom Gerät erkannt.
Collegare alla porta USB-C o USB-A e il dispositivo rileverà il mouse.
Ligar à porta USB-C ou USB-A e o dispositivo irá detetar o rato.
USB-C veya USB-A bağlantı noktasına takın, fare cihaz tarafından algılanacaktır.
USB-CまたはUSB-Aポートに接続すると、マウスがデバイスに検出されます。

FUNCTIONS

FONCTIONS | FUNCIONES | FUNKTIONEN | FUNZIONI | FUNÇÕES | FONKSIYONLAR | 機能

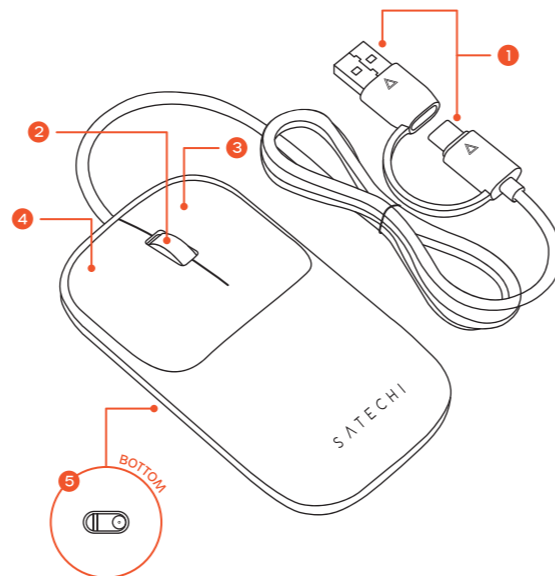

1. USB-C Connector with USB-C to USB-A Adapter

Connecteur USB-C avec adaptateur USB-C vers USB-A | Conector USB-C con adaptador USB-C a USB-A | USB-C-Anschluss mit USB-C-zu-USB-A-Adapter | Connettore USB-C con adattatore da USB-C a USB-A | Conector USB-C com adaptador USB-C para USB-A | USB-C Bağlayıcı ve USB-C'den USB-A'ya Adaptör | USB-Cコネクタ (USB-CからUSB-Aへのアダプター付き)

2. Scroll Wheel

Mollette de défilement | Rueda de desplazamiento | Scrollrad | Rotella di scorrimento | Roda de deslocamento | Kaydırma Tekerleği | スクロールホイール

3. Right Click Button

Bouton clic droit | Botón de clic derecho | Rechte Maustaste | Pulsante clic destro | Botão de clique direito | Sağ Tıklama Düğmesi | 右クリックボタン

4. Left Click Button

Bouton clic gauche | Botón de clic izquierdo | Linke Maustaste | Pulsante clic sinistro | Botão de clique esquerdo | Sol Tıklama Düğmesi | 左クリックボタン

5. Optical Sensor

Capteur optique | Sensor óptico | Optischer Sensor | Sensore ottico | Sensor ótico | Optik Sensör | 光学センサー

DIGITAL MANUAL

TIẾNG VIỆT | ΕΛΛΗΝΙΚΑ | SVENSKA | DANSK | SUOMI | ČEŠTINA | POLSKI | BAHASA MELAYU



For more languages, please scan the QR code

Để biết thêm ngôn ngữ, quét mã QR
Για περισσότερες γλώσσες, παρακαλώ σαρώστε τον κωδικό QR
För fler språk, skanna QR-koden
For flere sprog, scan QR-koden
Lisäkielille skannaa QR-koodi
Pro více jazyků naskenujte QR kód
Aby uzyskać więcej języków, zeskanuj kod QR
Untuk lebih banyak bahasa, imbas kod QR