

## QUICK GUIDE

# QI2 WIRELESS CAR CHARGER

1

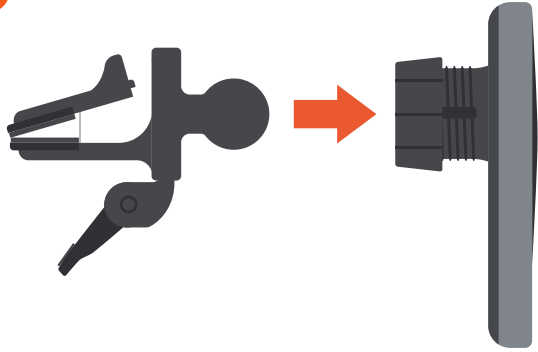

Snap in the mount piece to the backside of the Charger.

2

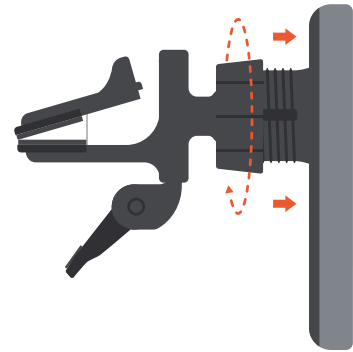

Twist the knob to tighten and secure the two pieces together.

3

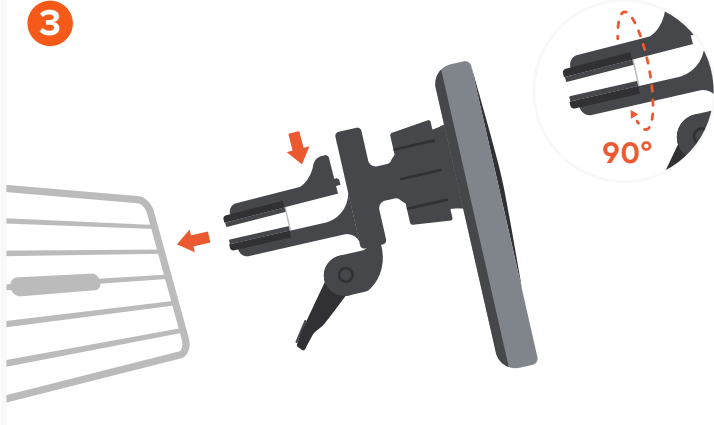

Push the lever to open the clamp and attach onto car's air vents. Rotate clamp 90° to fit onto vertical air vents. Fits most standard car vents.

4

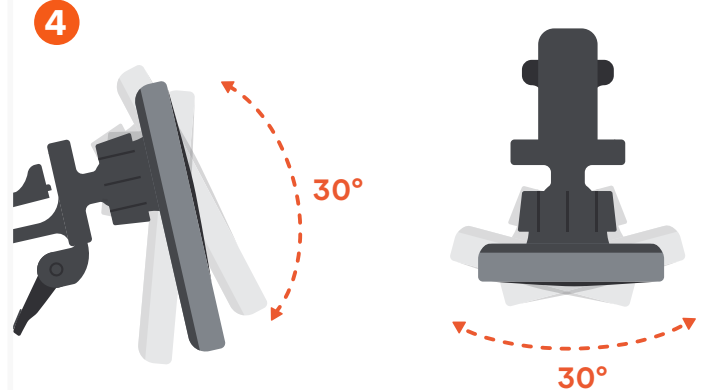

Once the Charger is mounted you can adjust its viewing angle by 30 degrees.

5

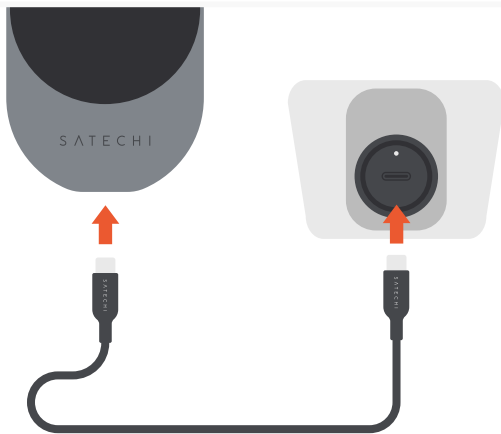

Plug the included 25W charger to your car's auxiliary power outlet and connect the included USB-C cable to the Charger. Car charger LED indicator will illuminate once connected to power.

6



Place compatible iPhone onto Qi2 Wireless Charger to begin charging. Up to 15W

Only iPhones that support MagSafe charging are compatible without the use of an additional magnetic attachment or supported MagSafe case (not included).

20W Power Adapter required for optimal use.