

• Si no hay sonido, tiene que ajustar los ajustes de salida del audio.

• Wenn kein Ton zu hören ist, müssen die Audioausgabeeinstellungen angepasst werden.

• Se non c'è suono, è necessario regolare le impostazioni dell'uscita audio.

• Ses yoksa, ses çıkış ayarlarının yapılması gerekir.

• Se não houver som, as configurações de saída de áudio precisam ser ajustadas.

• Если звука нет, необходимо отрегулировать настройки вывода звука.

• 音が出ない場合は、音声出力設定を調整する必要があります。

• 소리가 나지 않으면 오디오 출력 설정을 조정해야 합니다.

• 如果沒有聲音，則需要調整音頻輸出設置。

• 如果没有声音，则需要调整音頻輸出設置。

FCC

This device complies with part 15 of the FCC results. Operation is subject to the following two conditions:
1. This device may not cause harmful interference and
2. This device must accept any interference received, including interference that may cause undesired operation.
Note: This Equipment has been tested and found to comply with the limits for a class B digital device, pursuant to Part 15 of the Federal Communications Commission (FCC) rules. These limits are designed to provide reasonable protection against harmful interference in a residential installation. This equipment generates, uses, and can radiate radio frequency energy and, if not installed and used in accordance with the instructions, may cause harmful interference to radio communications. However, there is no guarantee that interference will not occur in a particular install



FUNCTIONS

FONCTIONS | FUNCIONES | FUNKTIONEN |
FUNZIONI | FONKSİYONLAR | FUNÇÕES |
ФУНКЦИИ | 機能 | 기능 | 功能 | 功能

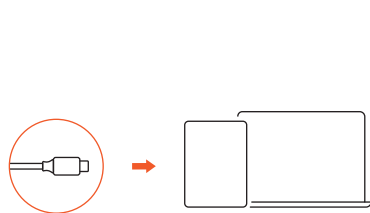

1. Connect to a laptop or tablet

Connecter à un ordinateur portable ou à une tablette | Conéctelo a una computadora portátil o tableta | Verbinden Sie sich mit einem laptop oder tablet | Conéctelo a una computadora portátil o tableta | Bir dizüstü bilgisayara veya tablete bağlanın | Подключить к ноутбуку или планшету | ノートパソコンまたはタブレットに接続する | 노트북 또는 태블릿에 연결 | 连接到筆記本電腦或平板電腦 | 连接到笔记本电脑或平板电脑

2. Connect your cables

Connectez vos câbles | Conecte sus cables | Schließen sie Ihre kabel an | Connetta i tuoi cavi | Kablolarınızı bağlayın | Conecte seus cabos | Подключите кабели | ケーブルを接続する | 케이블 연결 | 連接電纜 | 连接电缆

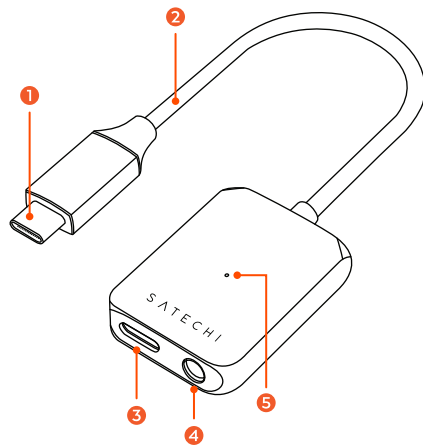

1. USB-C Connector

Connecteur USB-C | Conector USB-C | USB-C Anschluss | Connettore USB-C | USB-C Konektörü | Conector USB-C | Коннектор USB-C | USB-Cコネクター | USB-C 커넥터 | USB-C 接口 | USB-C 接口

2. Durable Braided Cable

Câble tressé durable | Cable trenzado duradero | Langlebiges geflochtenes Kabel | Cavo intrecciato resistente | Dayanıklı

Örgülü Kablo | Cabo trançado durável | Прочный плетёный кабель | 丈夫な編組ケーブル | 튼튼한 편조 케이블 | 耐用編織電纜 | 耐用编织电缆

3. USB-C PD Port (up to 30W)

Port USB-C PD (jusqu'à 30 W) | Puerto USB-C PD (hasta 30W) | USB-C PD-Anschluss (bis zu 30 W) | Porta USB-C PD (fino a 30 W) | USB-C PD Portu (30 W'a kadar) | Porta USB-C PD (até 30 W) | Порт USB-C PD (до 30 Вт) | USB-C PD 포트 (最大30W) | USB-C PD 포트(최대 30W) | USB-C PD 端口(高達 30W) | USB-C PD 端口(高达 30W)

4. Audio Jack Port (24-bit/96kHz)

Prise jack audio (24-bit/96kHz) | Puerto Jack de Audio (24 bits/96kHz) | 3,5mm Audiobuchse (24 bits/96kHz) | Porta jack audio (24 bits/96kHz) | Ses Jaki Bağlantı Noktası (24 bits/96kHz) | Porta de entrada de áudio (24 bits/96kHz) | Аудиоразъем (24 bits/96kHz) | オーディオジャックポート (24 bits/96kHz) | 오디오 잭 포트 (24 bits/96kHz) | 音頻插孔 (24 bits/96kHz) | 音頻插孔 (24 bits/96kHz)

5. LED Indicator

Indicateur LED | Indicador LED | LED-Anzeige | Indicatore LED | LED göstergesi | Indicador LED | Светодиодный индикатор | LED 인ジazeera | LED 표시기 | LED 指示燈 | LED 指示灯

IMPORTANT

IMPORTANT | IMPORTANTE | WICHTIG |
IMPORTANTE | ÖNEMLI | IMPORTANTE |
BAKHO | 重要 | 중대한 | 重要事項 | 注意

• The audio port supports a microphone and in-line media controls.

• Le port audio permet de contrôler le microphone et les fonctions en-ligne.

• El puerto de audio admite micrófono y los controles de medios en línea.

• Der Audioanschluss unterstützt Mikrofon- und In-line-Mediensteuerungen.

• La porta audio supporta il microfono e i controlli multimediali in linea.

• Ses bağlantı noktası, bir mikrofonu ve sıralı ortam denetimlerini destekler.

• A porta de áudio oferece suporte a um microfone e controles de mídia em linha.

• Аудиопорт поддерживает микрофон и встроенные средства управления мультимедиа.

• オーディオポートはマイクとインラインメディアコントロールをサポートします。

• 오디오 포트는 마이크와 인라인 미디어 컨트롤을 지원합니다.

• 音頻端口支持麥克風和嵌入式媒體控件。

• 音頻端口支持麥克風和嵌入式媒體控件。

• If there is no sound, audio output settings need to be adjusted.

• S'il n'y a pas de son, les paramètres de sortie audio doivent être ajustés.

