

65mm x 140mm

OUTSIDE

IMPORTANT

IMPORTANT | IMPORTANTE | WICHTIG | IMPORTANTE
| ÖNEMLİ | IMPORTANTE | ВАЖНО | 重要 | 중요한 |
重要信息 | 重要訊息

- Do not place any metallic objects onto the charger.
- Ne placez aucun objet métallique sur le chargeur.
- No coloque ningún objeto metálico sobre el cargador.
- Legen Sie keine metallischen Gegenstände auf das Ladegerät.
- Non collocare oggetti metallici sul caricatore.
- Şarj cihazının üzerine herhangi bir metal nesne koymayın.
- Não coloque objetos metálicos sobre o carregador.
- Не кладите металлические предметы на зарядное устройство.
- 充電器の上に金属物を置かないでください。
- 충전기 위에 금속 물체를 올려놓지 마십시오.
- 請勿將任何金屬物品放在充電器上。
- 請勿將任何金屬物品放在充電器上。

NEED HELP?

BESOIN D'AIDE POUR? | ¿NECESITA AYUDA? |
BRAUCHEN SIE HILFE? | HAI BISOGNO DI AIUTO? |
YARDIMA MI İHTİYACINIZ VAR? | PRECISO DE AJUDA?
| НУЖНА ПОМОЩЬ? | 助けが必要? | 도움이 필요하다?
| 需要幫忙? | 需要幫忙?

Manufacturer:
7365 Mission Gorge Rd. Ste. G
San Diego CA 92120 USA
+1 858 268 1800
support@satechi.com
www.satechi.net

UK Representative:
CMS Distribution Ltd.
CasOne Freeway Drive
CASTLEFORD W Yorkshire
WF10 5EJ, United Kingdom
+44 20 8962 2500
EORI: GB117202262000

EC REP

Authorized Representative:
QIMA EUROPE AR GmbH
Schleidenstraße 1
22083 Hamburg
GERMANY



This device complies with part 15 of the FCC rules.
Operation is subject to the following two conditions:

1. This device may not cause harmful interference and
2. This device must accept any interference received, including interference that may cause undesired operation.

Note: This Equipment has been tested and found to comply with the limits for a class B digital device, pursuant to Part 15 of the Federal Communications Commission (FCC) rules. These limits are designed to provide reasonable protection against harmful interference in a residential installation. This equipment generates, uses, and can radiate radio frequency energy and, if installed and used in accordance with the instructions, may cause harmful interference to radio communications. However, there is no guarantee that interference will not occur in a particular installation. If this equipment does cause harmful interference to radio or television reception, which can be determined by turning the equipment off and on, the user is encouraged to try to correct the interference by one or more of the following measures:

- 1.1. Reorient or relocate the receiving antenna
- 1.2. Increase the separation between the equipment and receiver
- 1.3. Connect the equipment into an outlet on a circuit different from that to which the receiver is connected
- 1.4. Consult the dealer or an experienced radio/TV technician for help

Caution: changes or modifications not expressly approved by the party responsible for compliance could void the user's authority to operate the equipment.

This equipment complies with FCC radiation exposure limits set forth for an uncontrolled environment. This transmitter must not be co-located or operating in conjunction with any other antenna or transmitter.



Satechi declares that this product is in compliance with the essential requirements and other relevant provisions of applicable EC directives. For Europe, a copy of the Declaration of Conformity for this product may be obtained by visiting www.satechi.net/doc

IC: 24917-STTCMCAWM

This device contains licence-exempt transmitter(s)/receiver(s) that comply with Innovation, Science and Economic Development Canada's licence-exempt RSS(s). Operation is subject to the following two conditions:

- (1) This device may not cause interference.
 - (2) This device must accept any interference, including interference that may cause undesired operation of the device.
- Cet appareil contient des émetteurs / récepteurs exempts de licence conformes aux RSS (RSS) d'Innovation, Sciences et Développement économique Canada. Le fonctionnement est soumis aux deux conditions suivantes:
- (1) Cet appareil ne doit pas causer d'interférences.
 - (2) Cet appareil doit accepter toutes les interférences, y compris celles susceptibles de provoquer un fonctionnement indésirable de l'appareil.



S A T E C H I

USB-C MAGNETIC CHARGING DOCK FOR APPLE WATCH

USER MANUAL



Manuel de l'utilisateur | Manual de Usuario |
Benutzerhandbuch | Manuale utente |
Kullanım Kılavuzu | Manual de usuário |
Руководство пользователя | ユーザーマニュアル |
사용자 매뉴얼 | 用戶說明 | 使用者說明

INSIDE

PLUG & PLAY

BRANCHEZ & JOUEZ | CONECTAR Y USAR | STECKEN & SPIELEN | COLLEGARE E GIOCARRE | TAK VE ÇALIŞTIR
| CONECTE E USE | ПОДКЛЮЧИ И РАБОТАЙ | プラグ&プレイ | 플러그 앤 플레이 | 即插即用 | 即插即用

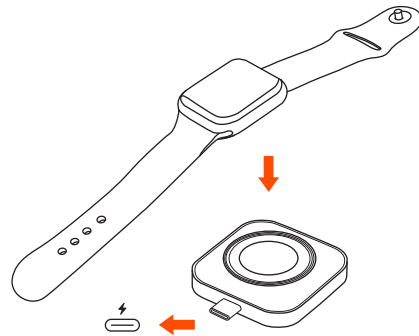

1. Plug the Magnetic Charging Dock into a powered USB-C port

Branchez la station de chargement magnétique sur un port USB-C alimenté

Conecte la base de carga magnética a un puerto USB-C con alimentación

Schließen Sie das magnetische Ladedock an einen USB-C-Anschluss mit Stromversorgung an

Collega il dock di ricarica magnetico a una porta USB-C alimentata

Manyetik Şarj Yuvasını elektrikli bir USB-C bağlantı noktasına takın

Conecte a Base de Carregamento Magnético a uma porta USB-C energizada

Подключите док-станцию с магнитной зарядкой к порту USB-C с питанием

磁気充電ドックを電源付きのUSB-Cポートに差し込みます

마그네틱 충전 도크를 전원 이 공급되는 USB-C 포트에 연결

將磁氣充電底座插入有源 USB-C 端口

將磁氣充電底座插入有源 USB-C 端口

2. Place the Apple Watch face up on the magnetic charging module

Placez l'Apple Watch face vers le haut sur module de charge magnétique

Coloque el Apple Watch boca arriba en el módulo de carga magnética

Legen Sie die Apple Watch mit der Vorderseite nach oben auf das magnetische Lademodul

Posiziona l'Apple Watch rivolto verso l'alto sul modulo di ricarica magnetico

Apple Watch'u yüzü yukarı bakacak şekilde manyetik şarj modülüne yerleştirin

Coloque o Apple Watch voltado para cima no módulo de carregamento magnético

Поместите Apple Watch лицевой стороной вверх на модуль магнитной зарядки

磁気充電モジュールにApple Watchを上向きに置きます

자기 충전 모듈에 Apple Watch 앞면이 위를 향하도록 놓습니다

將 Apple Watch 面朝上放在磁性充電模塊上

將 Apple Watch 面朝上放在磁性充電模塊上

FUNCTIONS

FONCTIONS | FUNCIONES | FUNKTIONEN | FUNZIONI |
FONKSİYONLAR | FUNÇÕES | ФУНКЦИИ | 機能 | 기능 |
功能 | 功能

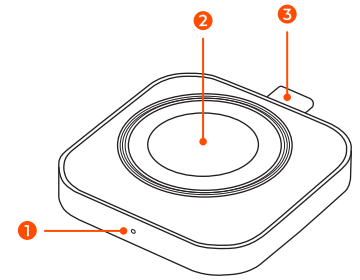

1. LED Indicator

Indicateur LED | Indicador LED | LED-Anzeige | Indicatore LED | LED göstergesi | Indicador LED | Светодиодный индикатор | LED インジケーター | LED 표시기 | LED 指示燈 | LED 指示灯

2. Magnetic Charger (Max. 5W)

Chargeur magnétique (Max. 5W) | Cargador Magnético (Máx. 5W) | Magnetisches Ladegerät (Max. 5W) | Caricabatterie magnetico (massimo 5W) | Manyetik Şarj Cihazı (Maks. 5W) | Carregador Magnético (Máx. 5W) | Магнитное зарядное устройство (макс. 5 Вт) | 磁氣充電器 (最大 5W) | 마그네틱 충전기 (최대 5W) | 磁氣充電器 (最大 5W) | 磁氣充電器 (最大 5W)

3. USB-C Connector

Connecteur USB-C | Conector USB-C | USB-C Anschluss | Connettore USB-C | USB-C Konektörü | Conector USB-C | Коннектор USB-C | USB-C 코넥터 | USB-C 커넥터 | USB-C 接口 | USB-C 接口