

# Dimensions: 75 x 135 mm

## IMPORTANT

IMPORTANT | IMPORTANTE | WICHTIG | IMPORTANTE | ÖNEMLİ  
| WAŻNY | IMPORTANTE | ВАЖНО | 重要 | 중요한 | 重要訊息 | 重要信息

### • USB-C charging port will not support data transfer or video output.

• Le port de charge USB-C ne prendra pas en charge le transfert de données ou la sortie vidéo.

• El puerto de carga USB-C no admite transferencia de datos ni salida de vídeo.

• Der USB-C-Ladeanschluss unterstützt keine Datenübertragung oder Videoausgabe.

• La porta di ricarica USB-C non supporterà il trasferimento di dati o l'uscita video.

• USB-C şarj portu veri aktarımını veya video çıkışını desteklemez.

• Port ładowania USB-C nie obsługuje przesyłania danych ani wyjścia wideo.

• A porta de carregamento USB-C não suporta transferência de dados ou saída de vídeo.

• Порт зарядки USB-C не поддерживает передачу данных или вывод видео.

• USB-C 充電ポートはデータ転送や映像出力に非対応です。

• USB-C 충전 포트는 데이터 전송 및 영상 출력을 지원하지 않습니다.

• USB-C 充電埠不支援資料傳輸或視訊輸出。

• USB-C 充電端口不支援數據傳輸或視頻輸出。

### • Direct HDMI-to-HDMI cable required for video output connection.

• Un câble HDMI direct HDMI-vers-HDMI est requis pour la connexion de sortie vidéo.

• Se requiere un cable directo HDMI-HDMI para la conexión de salida de vídeo.

• Direkte HDMI-zu-HDMI-Kabelverbindung für Videoausgang erforderlich.

• È richiesto un cavo HDMI-HDMI per la connessione dell'uscita video.

• Video çıkış bağlantısı için direkt HDMI-HDMI kablosu gereklidir.

• Do podłączenia wyjścia wideo wymagany jest bezpośredni kabel HDMI-HDMI.

• Um cabo direto HDMI-HDMI é necessário para conexão de saída de vídeo.

• Для подключения видеовывода требуется прямой кабель HDMI-HDMI.

• 直接のHDMI-to-HDMIケーブルが映像出力に必要です。

• 영상 출력을 위해서는 직접 HDMI-to-HDMI 케이블이 필요합니다.

• 視訊輸出連接需要HDMI到HDMI電纜。

• 視頻輸出連接需要HDMI到HDMI電纜。

### • 8K video output currently not supported on macOS.

• La sortie vidéo 8K n'est actuellement pas prise en charge sur macOS.

• La salida de vídeo 8K actualmente no es compatible con macOS.

• 8K-Videoausgabe wird aktuell nicht von macOS unterstützt.

• L'uscita video 8K attualmente non è supportata su macOS.

• 8K video çıkışı şu anda macOS'ta desteklenmemektedir.

• Wyjście wideo 8K nie jest obecnie obsługiwane w systemie macOS.

• Atualmente, a saída de vídeo 8K não é compatível com macOS.

• Вывод видео 8K в настоящее время не поддерживается на macOS.

• 8K 映像出力は現在 macOSではサポートされていません。

• 8K 비디오 출력은 현재 macOS에서 지원되지 않습니다.

• macOS目前不支援8K視訊輸出。

• macOS目前不支援8K視頻輸出。

### • Host device, external monitor and HDMI cable must support HDMI 2.1 technology in order to achieve 8K video output via HDMI.

• L'appareil hôte, le moniteur externe et le câble HDMI doivent prendre en charge la technologie HDMI 2.1 pour obtenir une sortie vidéo 8K via HDMI.

• El dispositivo host, el monitor externo y el cable HDMI deben ser compatibles con la tecnología HDMI 2.1 para conseguir una salida de vídeo 8K a través de HDMI.

• Host-Gerät, externer Monitor und HDMI-Kabel müssen die HDMI 2.1-Technologie unterstützen, um eine 8K-Videoausgabe über HDMI zu realisieren.

• Il dispositivo host, il monitor esterno e il cavo HDMI devono supportare la tecnologia HDMI 2.1 per ottenere un'uscita video 8K tramite HDMI.

• HDMI aracılığıyla 8K video çıkışı elde etmek için ana cihaz, harici monitör ve HDMI kablosunun HDMI 2.1 teknolojisini desteklemesi gerekir.

• Urządzenie hosta, zewnętrzny monitor i kabel HDMI muszą obsługiwać technologię HDMI 2.1 aby uzyskać wyjście wideo 8K przez HDMI.

• O dispositivo host, o monitor externo e o cabo HDMI devem suportar a tecnologia HDMI 2.1 para obter saída de vídeo de 8K por HDMI.

• Для обеспечения вывода видео 8K через HDMI хост-устройство, внешний монитор и кабель HDMI должны поддерживать технологию HDMI 2.1.

• HDMI經由8K映像出力に達するには、ホストデバイス、外部モニター、HDMIケーブルがHDMI 2.1 技術をサポートしている必要があります。

• HDMI를 통한 8K 비디오 출력을 위해서는 호스트 장치, 외부 모니터 및 HDMI 케이블이 HDMI 2.1 기술을 지원해야 합니다.

• 主機設備、外接顯示器和HDMI線纜必須支援HDMI2.1技術，才能透過HDMI實現8K視訊輸出。

• 主机设备、外接显示器和HDMI线缆必须支持HDMI2.1技术，才能通过HDMI实现8K视频输出。



This device complies with part 15 of the FCC rules. Operation is subject to the following two conditions:

1. This device may not cause harmful interference and  
2. This device must accept any interference received, including interference that may cause undesired operation.

**Note:** This Equipment has been tested and found to comply with the limits for a class B digital device, pursuant to Part 15 of the Federal Communications Commission (FCC) rules. These limits are designed to provide reasonable protection against harmful interference in a residential installation. This equipment generates, uses, and can radiate radio frequency energy and, if not installed and used in accordance with the instructions, may cause harmful interference to radio communications. However, there is no guarantee that interference will not occur in a particular installation. If this equipment does cause harmful interference to radio or television reception, which can be determined by turning the equipment off and on, the user is encouraged to try to correct the interference by one or more of the following measures:

- 1.1. Reorient or relocate the receiving antenna
- 1.2. Increase the separation between the equipment and receiver
- 1.3. Connect the equipment into an outlet on a circuit different from that to which the receiver is connected
- 1.4. Consult the dealer or an experienced radio/TV technician for help

Changes or modifications not expressly approved by the manufacturer could void the user's authority operate the equipment.



Satechi declares that this product is in compliance with the essential requirements and other relevant provisions of applicable EC directives. For Europe, a copy of the Declaration of Conformity for this product may be obtained by visiting <https://satechi.net/support/doc>



According to the WEEE (Waste Electrical and Electronic Equipment) Directive, do not dispose of this product as household waste or commercial waste. Waste electrical and electronic equipment should be appropriately collected and recycled as required by practices established for your country. For information on recycling of this product, please contact your local authorities, your household waste disposal service, or the shop where you purchased the product.

**CAN ICES-003 (B)/NMB-003(B)**  
This Class B digital apparatus complies with Canadian ICES-003.  
(Cet appareil numérique de la Classe B conforme à la norme NMB-003 du Canada).

S A T E C H I

## USB-C MULTIPOINT ADAPTER 8K WITH ETHERNET V3

### USER MANUAL



Manuel de l'utilisateur | Manual de usuario |  
Benutzerhandbuch | Manuale utente | Kullanım kılavuzu |  
Instrukcja obsługi | Manual de usuário | Руководство  
пользователя | ユーザーマニュアル | 사용자 매뉴얼 |  
使用者說明 | 用戶說明

## OUTSIDE

## INSIDE

### PLUG & PLAY

BRANCHEZ & JOUEZ | CONECTAR Y USAR | STECKEN & SPIELEN |  
COLLEGARE E GIOCARE | TAK VE ÇALIŞTIR | PODŁĄCZ I UŻYWAJ  
| CONECTE E USE | ПОДКЛЮЧИ И РАБОТАЙ | プラグ&プレイ |  
플러그 앤 플레이 | 即插即用 | 即插即用

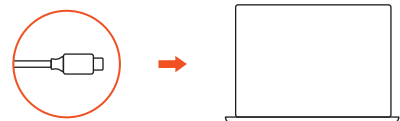

#### 1. Connect to a laptop

Connectez-vous à un ordinateur portable | Conecte a una computadora portátil | Mit einem Laptop verbinden | Collega a un laptop | Bir dizüstü bilgisayara bağlanın | Połączenie z laptopem | Conecte-se a um laptop | Подключите к ноутбуку | ノートパソコンに接続 | 노트북에 연결 | 连接到筆記型電腦 | 连接到笔记本电脑

#### 2. Connect your devices

Connectez vos appareils | Conecte sus dispositivos | Schließen Sie Ihre Geräte an | Collega i tuoi dispositivi | Cihazlarınızı bağlayın | Podłączenie urządzeń | Conecte seus dispositivos | Подключите свои устройства | お使いのデバイスを接続 | 기기 연결 | 连接到您的裝置 | 连接到您的设备

### FUNCTIONS

FONCTIONS | FUNCIONES | FUNKTIONEN | FUNZIONI | FONKSİYONLAR  
| FUNKCJE | FUNÇÕES | ФУНКЦИИ | 機能 | 기능 | 功能 | 功能

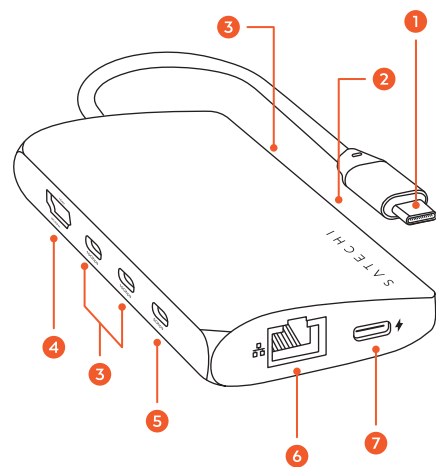

#### 1. USB-C Cable

Câble USB-C | Cable USB-C | USB-C-Kabel | Cavo USB-C |  
USB-C Kablosu | Kabel USB-C | Cabo USB-C | Кабель USB-C | USB-C  
Кабел | USB-C 케이블 | USB-C 線 | USB-C 線

#### 2. SD Card Slot (UHS-II)

Emplacement pour carte SD | Ranura para tarjeta SD |  
SD-Kartensteckplatz | Slot per scheda SD | SD Kart Yuvası |  
Czytnik kart SD | Slot para cartão SD | Слот для SD-карты |  
SD 카드로스롯 | SD 카드 슬롯 | SD卡插槽 | SD卡插槽

#### 3. 3X USB-C Data Ports (10 Gbps)

Ports de Données USB-C | Puertos de Datos USB-C | USB-C  
Datenanschlüsse | Porte Dati USB-C | USB-C Data Portları | Porty  
Danych USB-C | Portas de Dados USB-C | Порты Передачи Данных  
USB-C | USB-C 데이터포트 | USB-C 데이터 포트 | USB-C 數據連接埠  
| USB-C 數據端口

#### 4. HDMI Video Port (8K/30Hz or 4K/120Hz\*) (4K/60Hz\*\*)

Port Vidéo HDMI | Puerto de Vídeo HDMI | HDMI-Video-Anschluss |  
Porta Vídeo HDMI | HDMI Video Portu | Port Video HDMI | Porta de  
Vídeo HDMI | Порт Видео HDMI | HDMIビデオポート | HDMI 비디오  
포트 | HDMI 視訊連接埠 | HDMI 視頻端口

\* Windows OS

\*\* macOS

#### 5. USB-C Data Port (5 Gbps)

Port de Données USB-C | Puerto de Datos USB-C | USB-C-Datenanschluss  
| Porta Dati USB-C | USB-C Data Portu | Port Danych USB-C | Porta de  
Dados USB-C | Порт Передачи Данных USB-C | USB-C 데이터포트  
| USB-C 데이터 포트 | USB-C 數據連接埠 | USB-C 數據端口

#### 6. Ethernet Port (1 Gigabit)

Port Ethernet | Puerto Ethernet | Ethernet-Anschluss | Porta Ethernet  
| Ethernet Portu | Port Ethernet | Conexão de Rede | Порт Ethernet |  
이더넷포트 | 이더넷 포트 | 乙太網路埠 | 以太网端口

#### 7. USB-C PD Port (up to 85W)

Port USB-C PD | Puerto USB-C PD | USB-C PD-Anschluss | Porta USB-C  
PD | USB-C PD Portu | Port USB-C PD | Porta USB-C PD | Порт USB-C  
PD | USB-C PD 포트 | USB-C PD 포트 | USB-C PD 連接埠 | USB-C  
PD 端口

### NEED HELP?

BESOIN D'AIDE? | ¿NECESITA AYUDA? | BENÖTIGEN SIE  
HILFE? | HAI BISOGNO DI AIUTO? | YARDIMA MI  
İHTİYACINIZ VAR? | POTRZEBUJĘ POMOCY? | PRECISA  
DE AJUDA? | НУЖНА ПОМОЩЬ? | 助けが必要ですか? |  
도움이 필요하십니까? | 需要幫助? | 需要幫助?

Manufacturer:  
7365 Mission Gorge Rd. Ste. G  
San Diego, CA 92120, USA  
+1 858 268 1800  
support@satechi.com  
www.satechi.net

EU Authorized Representative:  
Chemical Inspection and Regulation  
Service Limited  
CRS, Regus Harcourt Centre  
Dublin, Ireland, D02 HX77  
+353 1 477 3710

UK Representative:  
Chemical Inspection and Regulation  
Service UK Ltd.  
Unit 536, Salisbury House  
London Wall, London, EC2M 5SQ  
+44 20 3289 6395

