

## QUICK GUIDE

# M1 BLUETOOTH MOUSE

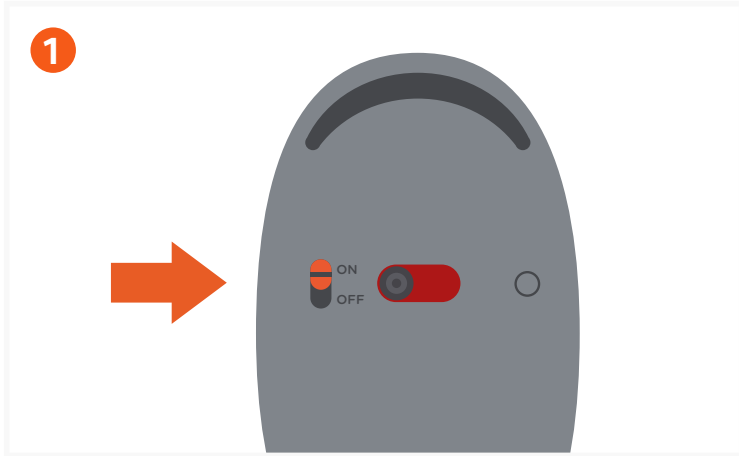

Turn on the M1 Bluetooth Mouse using its backside power switch.

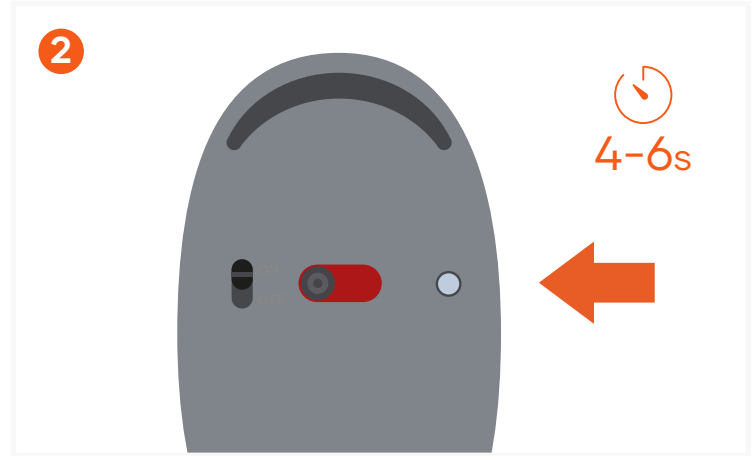

Put the mouse into pairing mode. Press and hold the Bluetooth button for 4-6 seconds. The button will flash blue

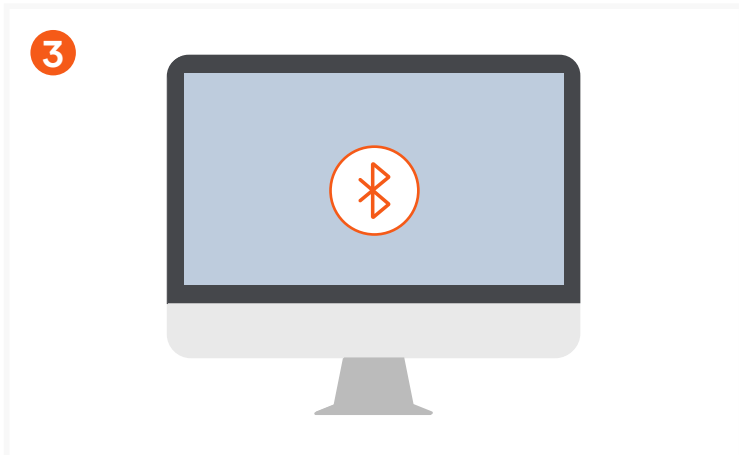

Turn on Bluetooth on your device and select "Satechi M1 Mouse" from the list.



Click "Connect" to finish the connection process.

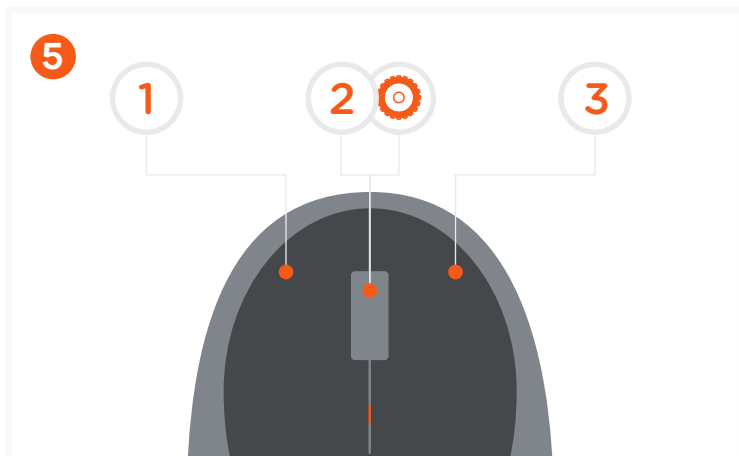

The mouse is equipped with 3 buttons and a scroll wheel.

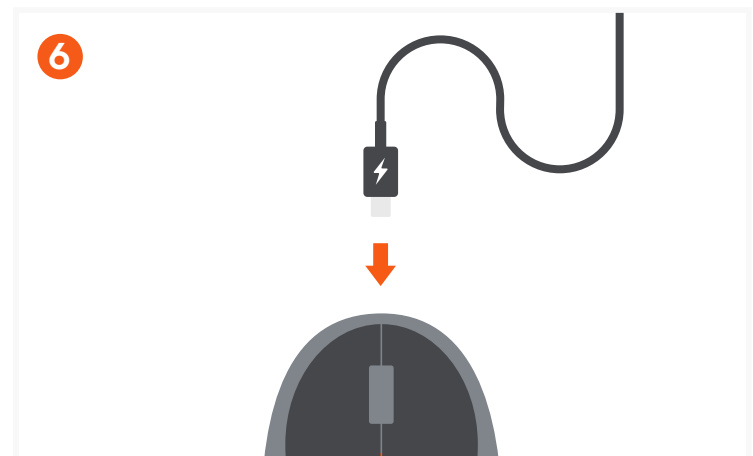

Recharge the mouse using the provided USB-C cable. Up to 45 days of use between charges