



This device complies with part 15 of the FCC rules. Operation is subject to the following two conditions:

1. This device may not cause harmful interference and
2. This device must accept any interference received, including interference that may cause undesired operation.

Note: This Equipment has been tested and found to comply with the limits for a class B digital device, pursuant to Part 15 of the Federal Communications Commission (FCC) rules. These limits are designed to provide reasonable protection against harmful interference in a residential installation. This equipment generates, uses, and can radiate radio frequency energy and, if not installed and used in accordance with the instructions, may cause harmful interference to radio communications. However, there is no guarantee that interference will not occur in a particular installation. If this equipment does cause harmful interference to radio or television reception, which can be determined by turning the equipment off and on, the user is encouraged to try to correct the interference by one or more of the following measures:

- 1.1. Reorient or relocate the receiving antenna
 - 1.2. Increase the separation between the equipment and receiver
 - 1.3. Connect the equipment into an outlet on a circuit different from that to which the receiver is connected
 - 1.4. Consult the dealer or an experienced radio/TV technician for help
- Changes or modifications not expressly approved by the manufacturer could void the user's authority operate the equipment.



Satechi declares that this product is in compliance with the essential requirements and other relevant provisions of applicable EC directives. For Europe, a copy of the Declaration of Conformity for this product may be obtained by visiting www.satechi.net/doc



According to the WEEE (Waste Electrical and Electronic Equipment) Directive, do not dispose of this product as household waste or commercial waste. Waste electrical and electronic equipment should be appropriately collected and recycled as required by practices established for your country. For information on recycling of this product, please contact your local authorities, your household waste disposal service, or the shop where you purchased the product.

+1 858 268 1800 | support@satechi.com

PLUG & PLAY

PLUG & PLAY | PLUG & PLAY | PLUG & PLAY | PLUG & PLAY | TAK ÇALIŞTIR | PLUG & PLAY | PLUG & PLAY | PLUG & PLAY | 플러그 앤 플레이 | 即插即用 | 即插即用



1. Connect to a laptop

Connectez-vous à un ordinateur portable
Conéctalo a un ordenador portátil
Verbinden mit einem Laptop
Collegare a un computer portatile
Bir dizüstü bilgisayara bağlanın
Подключите к ноутбуку
ラップトップに接続する | 노트북에 연결
连接到筆記本電腦 | 连接到笔记本电脑

2. Connect your devices

Connectez vos appareils
Conecta tus dispositivos
Schließen Sie Ihre Geräte an
Collega i tuoi dispositivi
Cihazlarınızı bağlayın
Conecte seus dispositivos
Подключите ваши устройства
デバイスを接続する | 장치 연결
連接您的設備 | 連接您的設備

S A T E C H I

USB-C™ PRO HUB MINI ADAPTER



Manuel d'utilisateur | Manual de usuario |
Bedienungsanleitung | Manuale dell'utente |
Kullanım kılavuzu | Manual do usuário |
Руководство пользователя | ユーザーマニュアル |
사용 설명서 | 用戶手冊 | 用戶手冊

FUNCTIONS

FONCTIONS | FUNCIONES | FUNKTIONEN | FUNZIONI |
FONKSİYONLAR | FUNÇÕES | ФУНКЦИИ | 機能 | 기능 | 功能 | 功能

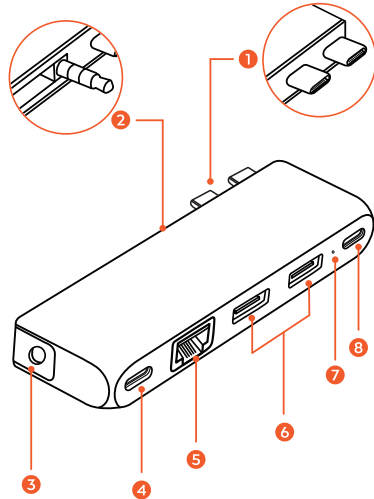

1. Dual USB-C Connectors

Deux connecteurs USB-C | Conectores duales USB-C |
Dual USB-C Anschlüsse | Connettori dual USB-C | Çift USB-C
Konektörleri | Conectores Duplos USB-C | Двойные разъемы
USB-C | 듀얼 USB-C 콘넥터 | 雙 USB-C 連接器 | 雙 USB-C 連接器

2. Audio Jack Connector

Connecteur jack audio | Conector de audio |
Audio-Buchsenanschluss | Connetttore jack audio | Ses Jaki

Konektörü | Conector de áudio | Разъем аудиоразъема | オー
ディオジャックコネクタ | 오디오 잭 커넥터 | 音頻插孔連接器 | 音
頻插孔連接器

3. Audio Jack Port

Prise jack audio | Puerto jack de audio | Audiobuchse | Porta
jack audio | Ses Girişi Bağlantı Noktası | Porta de entrada de
áudio | Audio Джек Порт | 音頻插孔 | 音頻插孔 | 오디오 잭 포트
| 音頻插孔 | 音頻插孔

4. USB4 Port

USB4 Port | Puerto USB4 | USB4-Anschluss | Porta USB4 | USB4
Portlar | Porta USB4 | Порт USB4 | USB4 포트 | USB4 端口 |
USB4端口 | USB4端口

5. Ethernet Port

Port Ethernet | Puerto Ethernet | Ethernet-Anschluss | Porta
Ethernet | Ethernet Bağlantı Noktası | Conexão de Rede | Порт
Ethernet | 이더넷 포트 | 以太網端口 | 以太網端口

6. 2X USB-A 3.1 Port Gen 1

Ports USB-A | Puertos USB-A | USB-A Anschlüsse | Porte USB-A |
USB-A Bağlantı Noktaları | Portas USB-A | Порты USB-A | USB-A
порт | USB-A 포트 | USB-A端口 | USB-A端口

7. LED Indicator

Indicateur LED | Indicador LED | LED-Anzeige | Indicatore LED |
LED göstergesi | Indicador LED | Светодиодный индикатор |
LED Индикатор | LED 표시기 | LED 指示燈 | LED 指示燈

8. USB-C Data Port

Port de données USB-C | Puerto de datos USB-C |
USB-C-Datenanschluss | Porta dati USB-C | USB-C Veri Bağlantı
Noktası | Porta de dados USB-C | Порт передачи данных USB-C
| USB-C 데이터 포트 | USB-C 데이터 포트 | USB-C數據端口 | USB-C數
據端口

IMPORTANT

IMPORTANT | IMPORTANT | WICHTIG | IMPORTANTE |
ÖNEMLİ | IMPORTANTE | ВАЖНО | 重要 | 重要事項
| 注意

• Connected USB devices should not exceed an input current of 900mA.

• Les appareils USB connectés ne doivent pas dépasser un courant d'entrée de 900mA.

• Dispositivos USB conectados no deben exceder una entrada de corriente de 900mA.

• Angeschlossene USB-Geräte sollten eine Eingangsstromstärke von 900 mA nicht überschreiten.

• I dispositivi USB collegati non devono superare un ingresso di corrente di 900mA.

• Bağlanan USB aygıtları 900mA giriş akımını geçmemelidir.

• Dispositivos USB conectados não devem exceder uma corrente de entrada de 900mA.

• Подключенные USB-устройства не должны превышать входной ток 900mA.

• 接続されたUSB機器は900mAの入力電流を超えてはいけません。

• 연결된 USB 장치는 900mA의 입력 전류를 초과하지 않아야 합니다.

• 連接的USB設備不應超過900mA的輸入電流。

• 連接的USB設備不應超過900mA的輸入電流。